

# PROJECT INFORMATION

**APPLICANT:**  
DAVID KIRTMAN

**DRAWINGS BY:**  
ECCO DESIGN INC.  
203 N 36TH ST SUITE 201  
SEATTLE, WA 98103  
206-706-3937

**SITE ADDRESS:**  
7439 W MERCER WAY  
MERCER ISLAND, WA 98040

**PARCEL NUMBER:**  
252404-9026

**BODY OF WATER:**  
LAKE WASHINGTON

**LEGAL DESCRIPTION:**  
LOTS 1 & 2 TGW SH LDS ADJ LESS E 186.00 FT OF SD LOT 2 MERCER ISLAND SHORT PLAT NO M I 90-12-28 REC NO 9211039001 SD SHORT PLAT DAF- N 91.5 FT OF S 191.5 FT OF POR GL 4 SEC 25-24-4 DAF - BEG AT SE COR SD GL 4 TH N ALG E LN THOF 383 FT M/L TAP 945.5 FT S OF NE COR SD GL 4 TH DUE WEST TO SHORE LINE OF LAKE WASHINGTON TH S ALG SD SHORE LINE TO S LN SD GL 4 TH EAST TO POB TGW SHORE LANDS ADJ LESS POR LY ELY OF WLY MGN OF W MERCER WAY TGW S 72 FT OF SD GL 4 DAF - BEG AT NE COR SD GL 4 TH S 1-25 W ALG E LN 945.5 FT TH N 88-45 W PLW S LN SD GL 4 730 FT M/L TO WLY MGN OF W MERCER WAY TH S 9-39 W ALG SD WLY MGN 103.73 FT TO TPOB TH N 88-45 W 176.94 FT TH S 1-15 W 90 FT TH S 88-45 E 163.65 FT TO WLY MGN SD W MERCER WAY TH N 9-39 E ALG SD WLY MGN 90.98 FT TO TPOB - AKA PARCEL A OF MERCER ISLAND BOUNDARY LN REV NO 93-0413 REC NO 9311019008

**PROJECT DESCRIPTION:**  
REPAIR AN EXISTING PIER BY SPLICING THIRTY FIVE WOOD PILES. INSTALL TWO MOORING PILES.

# VICINITY MAP

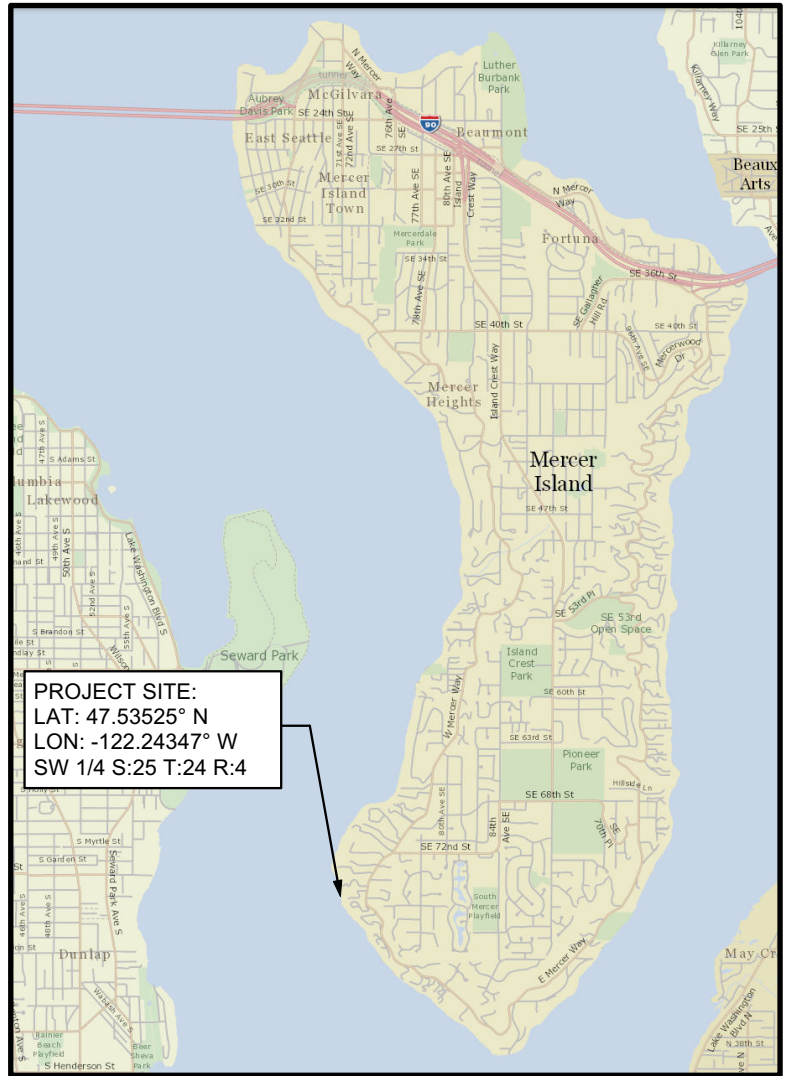

## REFERENCE:

**DATUM:** C.O.E. Locks Datum

## ADJACENT PROPERTY OWNERS:

1. Leslie Vice
2. Vance & Judy Gribble

**APPLICANT:** David Kirtman

**LOCATION:** 7439 W Mercer Way  
Mercer island, WA 98040

**LAT/LONG:** 47.53525°/-122.24347°

## PROPOSED PROJECT:

Repair Piles  
**IN:** Lake Washington  
**NEAR/AT:** Mercer Island  
**COUNTY:** King **STATE:** WA

**SHEET** 1 of 4

**DATE:** April 29, 2021

PLEASE NOTE THAT THE SHORELINE CONFIGURATION AND PROPERTY LINE LOCATIONS ARE APPROXIMATE ONLY. PROPERTY LINES WERE NOT SURVEYED.

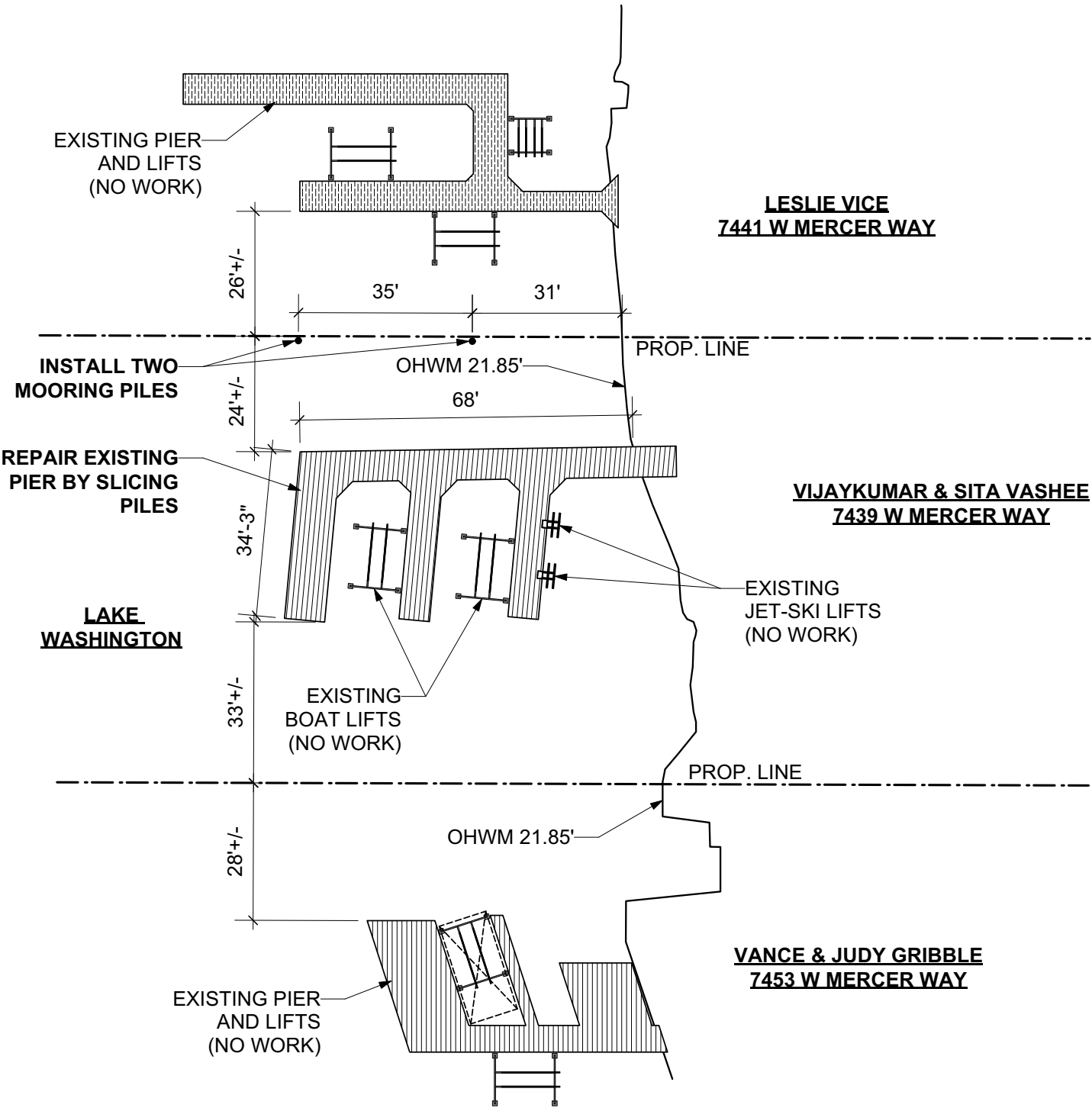

# SITE PLAN

SCALE 1" = 30'-0"



Reference:  
Applicant: David Kirtman

Proposed: Repair Piles  
Location: Mercer Island, WA

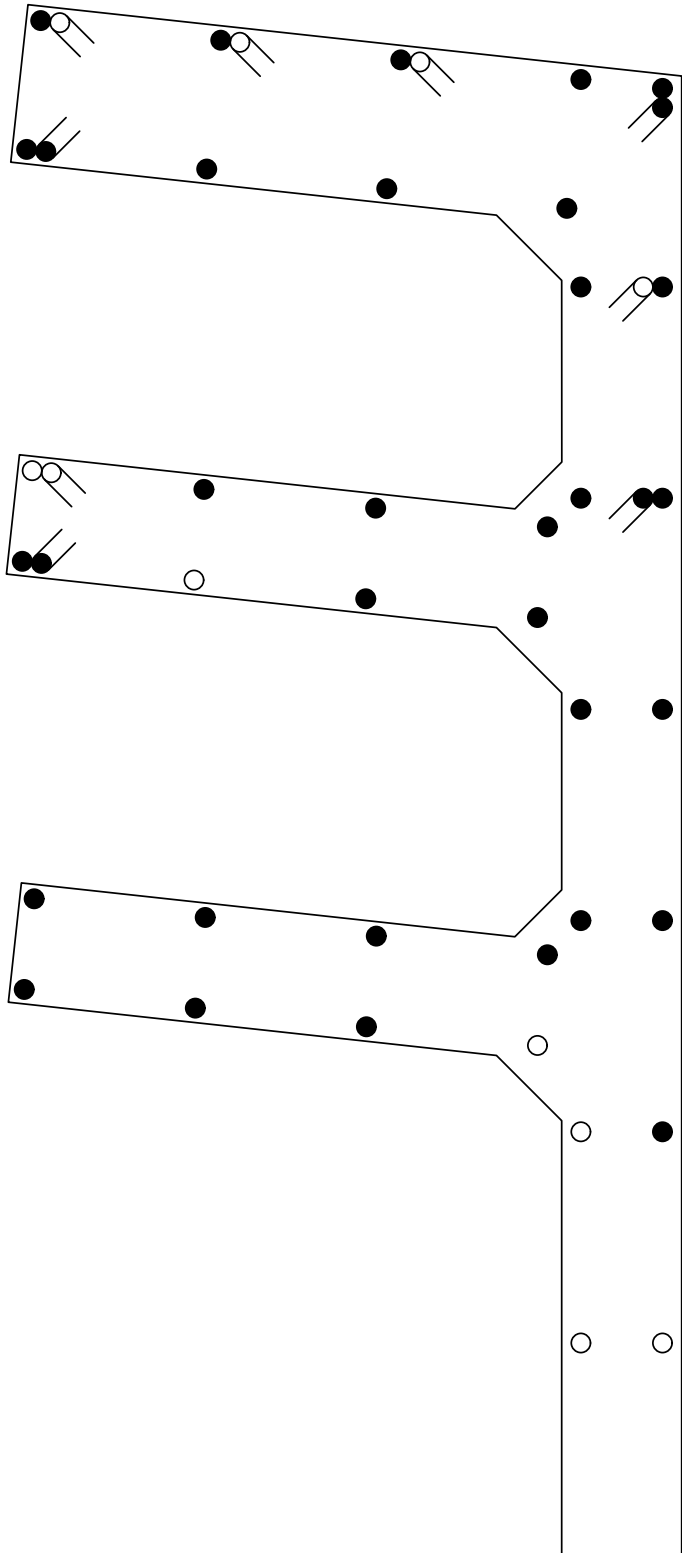

**LEGEND**

- EXISTING WOOD PILE TO REMAIN (6 TOTAL)
- EXISTING WOOD PILE TO BE SPLICED (31 TOTAL)
- ⌢ EXISTING WOOD BATTER PILE TO REMAIN (5 TOTAL)
- ⌢● EXISTING WOOD BATTER PILE TO BE SPLICED (4 TOTAL)

**PILE REPAIR PLAN**

SCALE 1" = 10'-0"

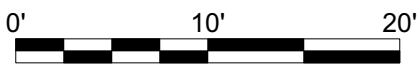

**Reference:**  
**Applicant:** David Kirtman

**Proposed:** Repair Piles  
**Location:** Mercer Island, WA

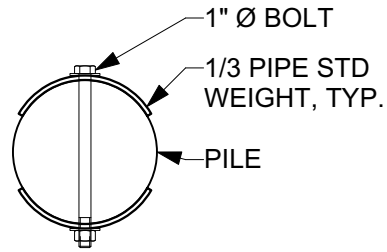

## **PILE SPLICE SECTION**

SCALE 3/4" = 1'-0"

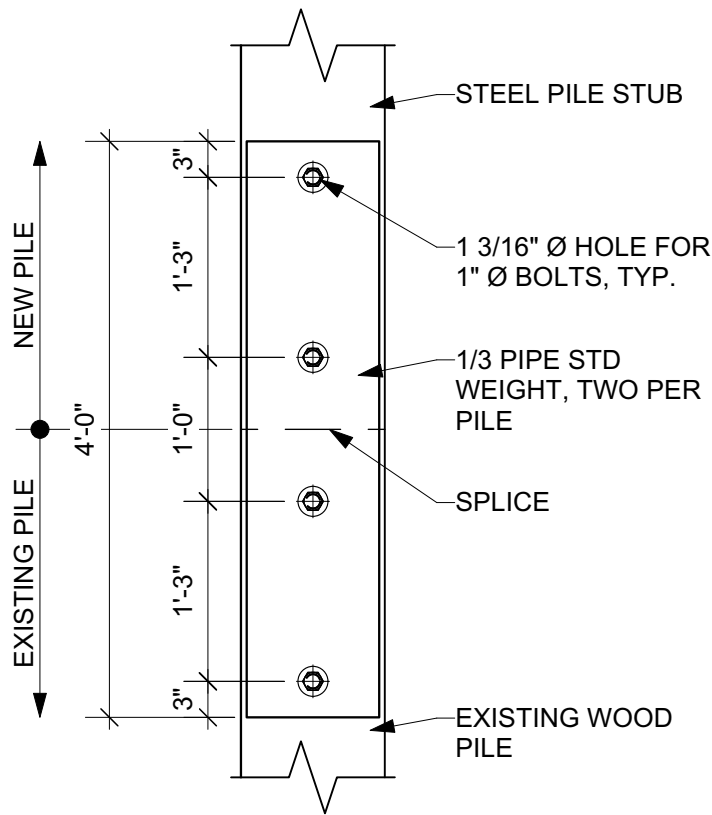

## **PILE SPLICE - SIDE VIEW**

SCALE 3/4" = 1'-0"



**Reference:**  
**Applicant:** David Kirtman

**Proposed:** Repair Piles  
**Location:** Mercer Island, WA